

## Parte externa termostático ducha emp. 2 salidas SMOOTH X32\_X3018100

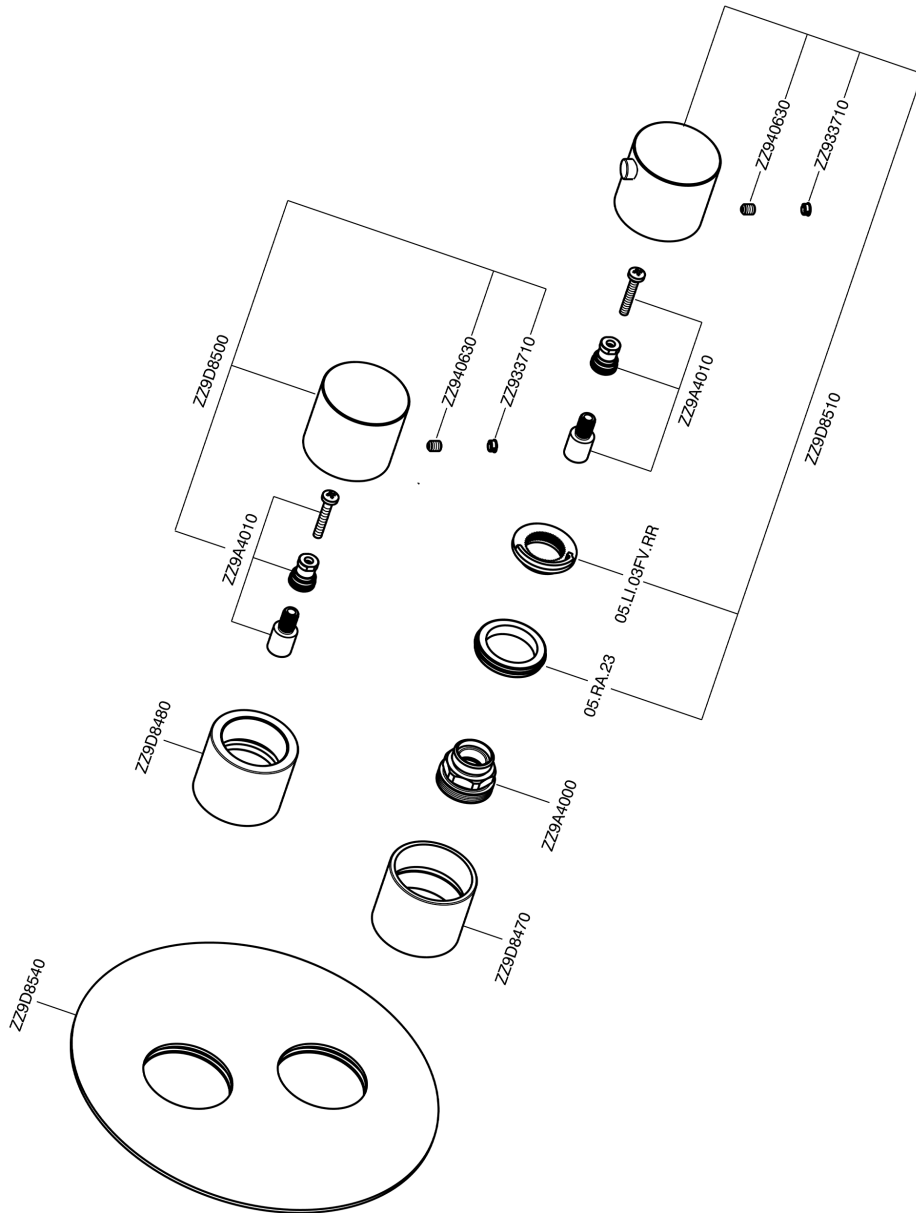

X3018100

<https://es.cisal.it/parte-externa-termostatico-ducha-emp-2-salidas-smooth-x32x3018100>

## Parte empotrada termostático ducha 2 salidas EMPOTRADO\_ZA018101

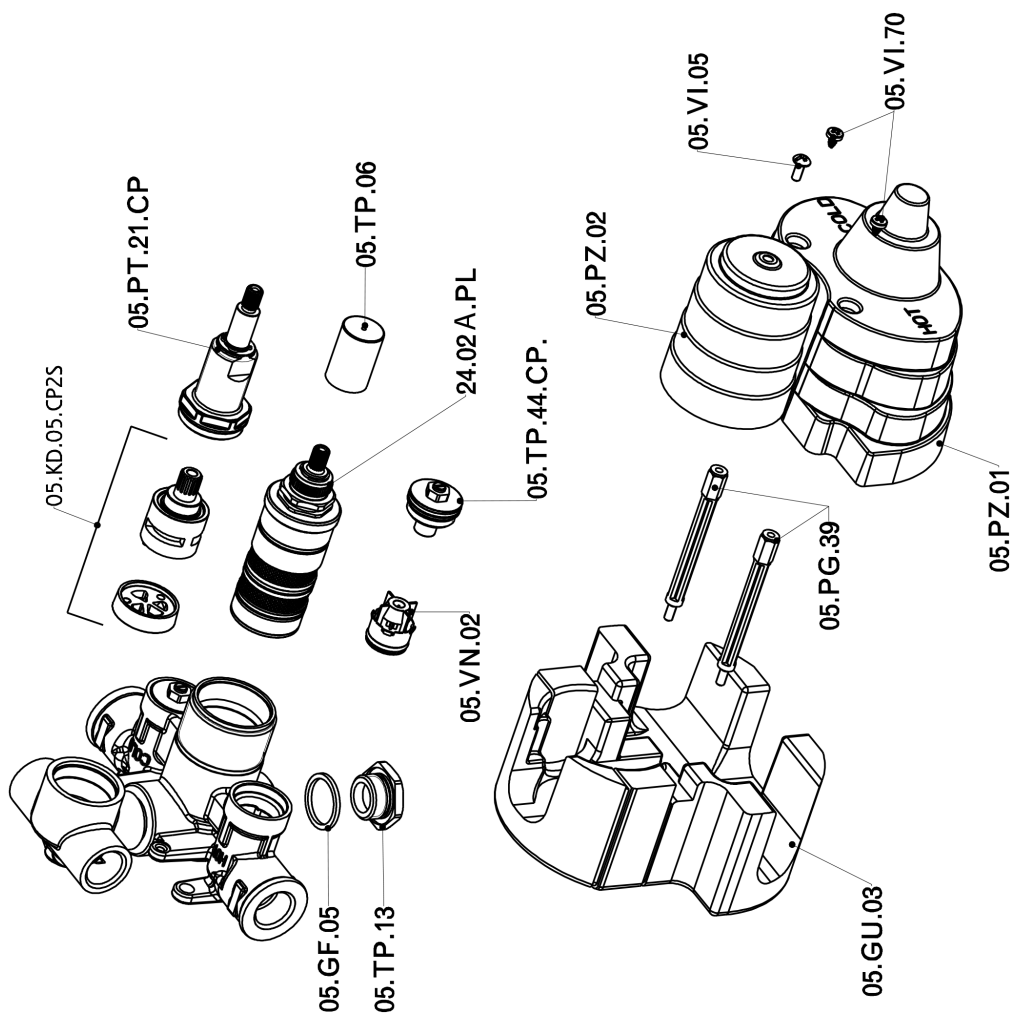

ZA018101

<https://es.cisal.it/parte-empotrada-termostatico-ducha-2-salidas-empotradoza018101>

2024-09-19